

|  |                 |                    |                         |
|--|-----------------|--------------------|-------------------------|
| DRAWING STANDARDS:                               |                 |                    |                         |
| DIMENSION UNITS ARE INCHES                       |                 |                    |                         |
| 1. ALL CORNER RADII R0.30                        | ∠ ±0.5°         | // PARALLELISM     | TOLERANCES: .XX ±0.015  |
| 2. BREAK ALL EDGES 0.015 X 45° OR R.015          | ○ ROUNDNESS     | ⊥ PERPENDICULARITY | .XXX ±0.005             |
| 3. HIGBEE ALL ACME THREADS TO FULL WIDTH         | ◎ CONCENTRICITY | ↗ RUNOUT           | ∠ ±0.5°                 |
| 4. REFERENCE DIMENSIONS ARE IN PARENTHESIS       | ⊙ CYLINDRICITY  | □ COUNTERBORE      | UNLESS OTHERWISE STATED |
| 5. MACHINED SURFACES ARE 125 Ra                  | ∇ FLATNESS      | ∨ COUNTERSINK      |                         |
| 6. ALL DIAMETERS CONCENTRIC AND ROUND TO ± 0.005 |                 |                    |                         |
| 7. TOLERANCES: .XX ±0.015 ∠ ±0.5°                |                 |                    |                         |
| .XXX ±0.005                                      |                 |                    |                         |

|                    |  |           |                 |
|--------------------|--|-----------|-----------------|
| ECN NO:            | CHANGES INCLUDE:                                 |           |                 |
| ECN DATE:          |  |           |                 |
| MATERIAL SPEC:     | TITLE: CHOKE-ADJUSTABLE, 3"1502 FM STD 15K 2"MAX |           | REVISION: 0     |
| RAW MATERIAL DESC: | DWG NO. CAAC3FM-S01                              |           | DATE: 7/24/2008 |
| WEIGHT: 162.52     | DRAWN BY: SR                                     | CHK'D: JF | APP'VD: KB      |
|                    | SHEET 1 OF 2                                     |           |                 |

DO NOT SCALE DRAWING

THIS DRAWING IS PROPRIETARY AND CONFIDENTIAL PROPERTY. THIS DOCUMENT CANNOT BE REPRODUCED OR DISTRIBUTED WITHOUT THE WRITTEN CONSENT OF PHOINIX GLOBAL LLC.

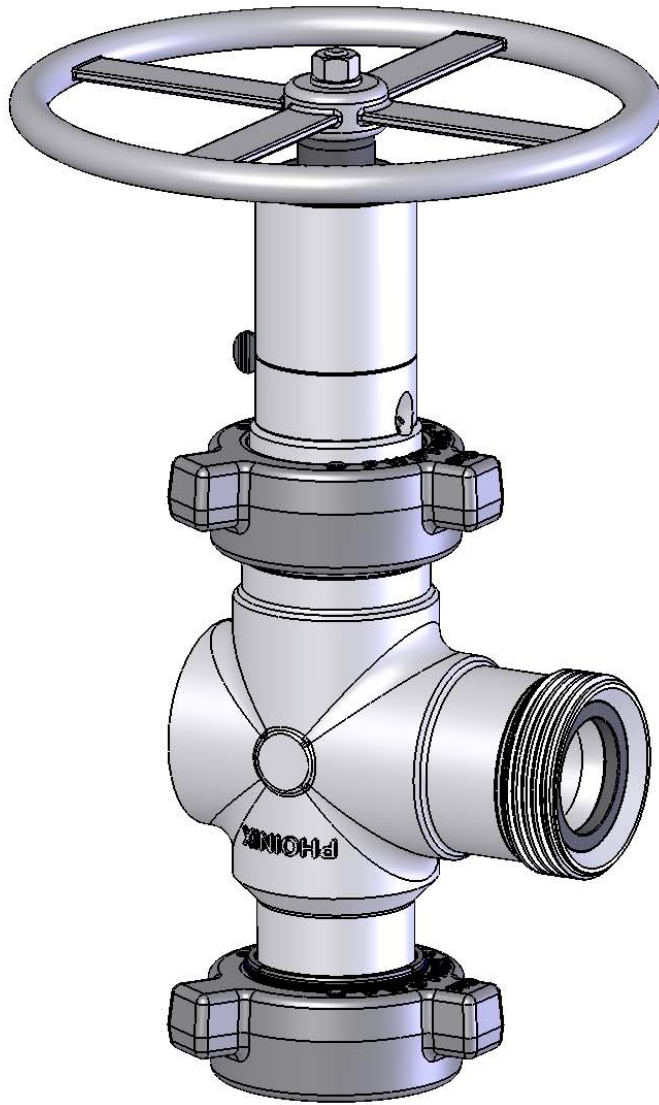

| ITEM NO. | PART NUMBER          | DESCRIPTION                                 | QTY. |
|----------|----------------------|---|------|
| 1        | CBC3FM-S01           | CHOKE BODY, 3"1502 FM STD 15K               | 1    |
| 2        | CBB003-S01           | CHOKE BONNET BODY, 3"1502 STD 15K           | 1    |
| 3        | CBB004               | CHOKE BONNET BODY EXTENSION, 3"             | 1    |
| 4        | GF002                | GREASE FITTING, ZERK 1/4"NPT                | 1    |
| 5        | UWN-3C-D-S           | WINGNUT, 3"1502 STD 15K DETACHABLE          | 2    |
| 6        | UNRC3                | NUT RETAINER, 3"1502                        | 1    |
| 7        | URRC3                | RETAINER RING, 3"1502                       | 1    |
| 8        | USR3-S01             | SEAL RING, 3"602/1002/1502 STD BUNA 90      | 1    |
| 9        | CST003               | CHOKE SEAT, 2"MAX H2-STYLE                  | 1    |
| 10       | CS003-H01            | CHOKE STEM, 2"MAX H2S 15K LONG (H2-STYLE)   | 1    |
| 11       | CP002-H01            | CHOKE PACKING, 3" H2S 15K                   | 1    |
| 12       | COR001               | CHOKE BONNET O-RING, 3" H2S HSN 90          | 1    |
| 13       | COR001-B             | CHOKE BONNET O-RING BACKUP, 3" H2S HSN 90   | 1    |
| 14       | CI001                | CHOKE INDICATOR, 2"MAX H2-STYLE             | 1    |
| 15       | CH002                | CHOKE HANDWHEEL, 3" CHOKE (H2-STYLE)        | 1    |
| 16       | F-HN0.63-11-G5       | HEX NUT, 5/8"-11 GRADE 5                    | 1    |
| 17       | F-WFS-0.625          | WASHER, FLAT STD 5/8"                       | 1    |
| 18       | H0029                | BALL, 5/16" BRASS                           | 2    |
| 19       | F-TS0.375X1.00-F     | THUMB SCREW, 3/8"-16 x 1.00"LONG FLAT POINT | 1    |
| 20       | F-WLH-0.38           | WASHER, LOCKING HIGH-COLLAR 3/8"            | 2    |
| 21       | F-SHC0.38-16X0.75-G5 | CAP SCREW, SOC HD 3/8"-16 x 00.75"LONG      | 2    |



DRAWING STANDARDS:

DIMENSION UNITS ARE INCHES

- ALL CORNER RADII R0.03
- BREAK ALL EDGES 0.015 X 45° OR R.015
- HIGBEE ALL ACME THREADS TO FULL WIDTH
- REFERENCE DIMENSIONS ARE IN PARENTHESIS
- MACHINED SURFACES ARE 125 Ra
- ALL DIAMETERS CONCENTRIC AND ROUND TO ± 0.005
- TOLERANCES: .XX ±0.015 < ±0.5°  
.XXX ±0.005

< ±0.5°

○ ROUNDNESS

◎ CONCENTRICITY

⊘ CYLINDRICITY

▭ FLATNESS

// PARALLELISM

⊥ PERPENDICULARITY

↗ RUNOUT

□ COUNTERBORE

∨ COUNTERSINK

TOLERANCES: .XX ±0.015  
.XXX ±0.005  
< ±0.5°  
UNLESS OTHERWISE STATED

ECN NO:

CHANGES INCLUDE:

ECN DATE:

MATERIAL SPEC:

RAW MATERIAL DESC:

WEIGHT: 162.52

TITLE: CHOKE-ADJUSTABLE, 3"1502 FM STD 15K 2"MAX

DWG NO. CAAC3FM-S01

DRAWN BY: SR    CHK'D: JF    APP'V'D: KB

REVISION:  
0  
DATE:  
7/24/2008

SHEET 2 OF 2

DO NOT SCALE DRAWING

THIS DRAWING IS PROPRIETARY AND CONFIDENTIAL PROPERTY. THIS DOCUMENT CANNOT BE REPRODUCED OR DISTRIBUTED WITHOUT THE WRITTEN CONSENT OF PHOINIX GLOBAL LLC.